



FIBERSHIELD

-/60/60

FIRE SHUTTER / OPERABLE WALL



A thermally insulated textile fire shutter, this system provides a fire barrier with a Fire Resistance Rating of -/60/60 when tested in accordance with AS1530.4 and does not require sprinklers to achieve this rating.

The multi-layer design of the fire protection curtain comprising alternating layers of insulating and cooling material allows the sparing use of the textiles and a reduction of the weight compared to conventional models. Fibershield -/60/60 fire and shutter /operable wall can be integrated into both existing and new buildings and requires little construction space above a wall opening. Due to the low weight and construction space, the Fibershield -/60/60 system is also ideal for modifying or refitting fire protection elements in existing buildings.

- Deemed-to-Satisfy solution
- Fire tested in accordance with AS1530.4
- No sprinklers required
- Maximum sizes up to 4 m wide x 4m drop





FIBERSHIELD -/60/60 Fire shutter / Operable Wall

I COMPLIANCE

Fibershield -/60/60 fire shutters can be supplied, installed and certified for fire ratings up to -/60/60 in accordance with AS1530.4. The system complies with the requirements of EN12101.1 Smoke Curtains. As the system is fully insulated it may be considered as a deemed-to-satisfy moveable fire rated wall.

TARGET	PERFORMANCE DATA	RESULTS
FIRE PROTECTION	Fire Shutter	Complies with AS1905.2
	Fire Rating	-/60/60 when fire tested in accordance with AS1530.4 without the need for sprinklers
	Permeability	<25m ³ /hour when (fabric only) tested in accordance with EN12101.1
SMOKE PROTECTION	Spread of Flame	0, 0, 0, 2 when tested in accordance with AS1530.3
	Group Number	Group 1 when tested in accordance with AS3837
	Cycle Test	2,000 open-close cycles
FUNCTIONALITY	Operating Speed	4.5 m/min (nominal)
	Maximum Pressure Differential	40Pa when fully closed
	System Weight	
	Maximum Sizes	6400 mm max width x 4400 mm max drop

What you need to know

The Fibershield -/60/60 provides full fire integrity and insulation for 60 minutes without the need for sprinklers.

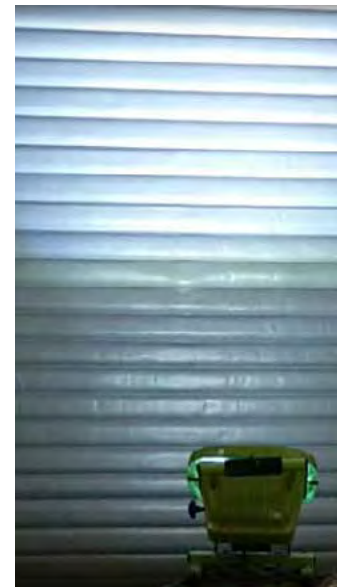
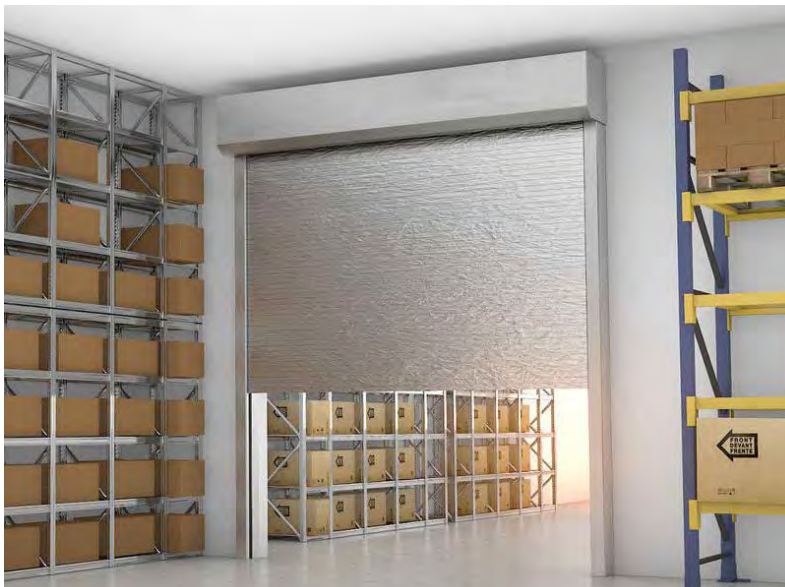

| Fibershield -/60/60 unique barrier provides full insulation equivalent to a fire resistant wall when fully deployed

I WHAT YOU NEED TO KNOW

SYSTEM OPERATION

The system is typically in the open position during normal building use. On receipt of an alarm, the Fibershield –/60/60 fire shutter deploys to provide fire and smoke compartmentation. On reset of the Fire Indicator Panel, the system automatically rewinds back into the standby position.

The control box is a compact system providing battery back up as standard. The controller requires a standard 240V,

10A power supply and an alarm signal in the form of a normally closed dry contact. A localised smoke or heat detector may also be used to activate the system. Please contact our technical department for details on 1300 665 471.



| Fibershield –/60/60 can be used as an operable wall to protect combustible assets.

EGRESS

When Fibershield –/60/60 fire shutters are used as part of the egress strategy, rewind switches can be connected directly to the standard control box. The switches can be mounted on one or both sides of the wall. Once pressed the system will retract and then redeploy. The retraction is based on a timer. This timer can be set to open the curtain to a minimum height before redeployment.

INSTALLATION

In line with Smoke Control's mission to provide customers with reliable solutions, the Fibershield –/60/60 system is installed by our fully trained and approved installer network.

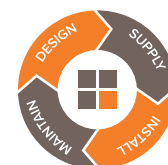

MAINTENANCE

As with all essential services Fibershield –/60/60 should be maintained in strict accordance with our documented procedures by fully trained and competent technicians. Operational tests alone are not considered adequate and when conducted by inexperienced personnel, may lead to damage of the product. Smoke Control offers a comprehensive preventative maintenance program which has proven cost savings over the life of the product.

Please contact our maintenance department for details on 1300 665 471.



FIBERSHIELD -/60/60 Fire shutter / Operable Wall



APPLICATIONS

Ideal for small to medium openings, Fibershield -/60/60 fire shutters can be used to provide fire and smoke compartmentation in:

- museums
- art galleries
- hospitals
- escape paths
- server openings
- fire compartmentation between tenancies

ACCESSORIES

- battery backup
- rewind switches
- curtain applied signage

PRODUCT DIMENSIONS

| Head box detail (drop height up to 2.5m)

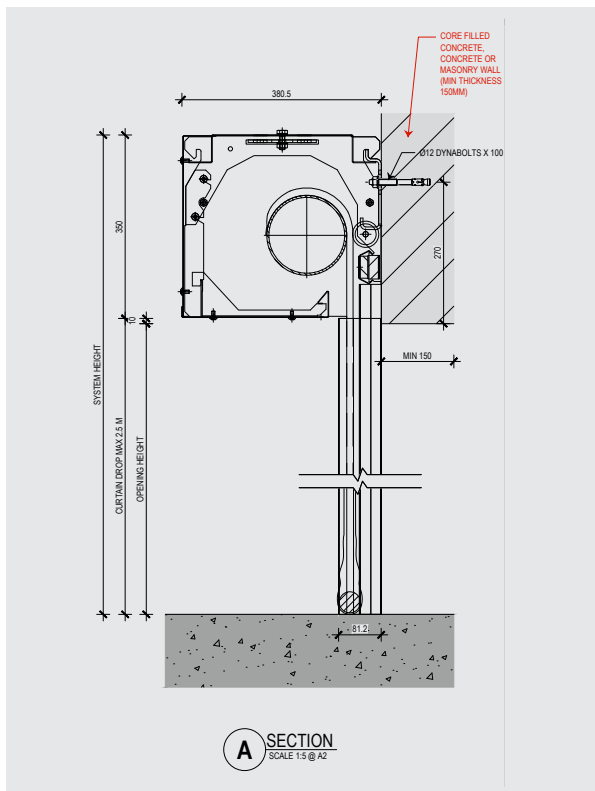



GENERAL INFORMATION

I TECHNICAL SUPPORT



Smoke Control offers obligation free technical support and pricing throughout your design and documentation stage so you can accurately prepare your budgets through value engineering.

You can also download the set of specifications, drawings and technical data from our website www.smokecontrol.com.au.

Contact our technical department to discuss your project requirements, or feel free to arrange a meeting.

Australia
1300 665 471

International
+61 2 96814000

New Zealand
+64 9 300 1980

A LITTLE MORE ABOUT US...

Smoke Control was established in 2003. We partner with leading local and international organisations to work with the new performance-based design environment - in addition to the traditional prescriptive environment - designing and installing systems to meet the challenging fire and smoke control demands of modern buildings.

Constant research and development continue to enhance our offering of fire windows, fire shutters and fire & smoke curtains, bringing the most innovative technology to both regular and unique project challenges. If you cannot find what you are looking for, please contact our team as we may already have a solution for you.

Smoke Control services all regions in Australia and New Zealand via our own offices and people. International customers can contact our Australian office by phone or email for your nearest distributor.

*We believe people deserve to work & live
in safe & beautiful buildings*

